

**MY24** 

# **NEW ENDURO BIKE LAUNCH**



**SHERCO**



**WATCH THE VIDEO**









► INDEX

**5****ENDURO NEW RANGE****7****CYCLE PARTS IMPROVEMENTS****125** SE **FACTORY****250 | 300** SE **FACTORY****250 | 300** SE **FACTORY****21****ENGINE IMPROVEMENTS****250 | 300** SE **FACTORY****33****450-500CC  
IMPROVEMENTS****SHERCO**



# ENDURO NEW RANGE

2T STROKE

125 SE

250  
300 SE

4T STROKE

250  
300 SEF

450  
500 SEF



SHERCO



**ENDURO**  
**FACTORY**



# CYCLE PARTS IMPROVEMENTS

➤ NEW 2024 GRAPHICS KIT.



**4T STROKE**



**2T STROKE**

FULL RANGE

**SHERCO**



# HEADLIGHT



- New Sherco visual identity, common to all models.
- New headlight housing with LED headlight.

FULL RANGE

**SHERCO**



# FRONT FENDER



- New front fender design.
- Lighter and wider, provides improved protection from mud splashes.



FULL RANGE

**SHERCO**



# FRONT BRAKE HOSE GUIDE



- New front brake hose guides (two instead of one).



# FRAME



- New single color paint.
- More resistant to scratches and abrasions.

FULL RANGE

**SHERCO**



# TRANSMISSION



- New aluminum rear sprocket.
- Weight reduction.

FULL RANGE

**SHERCO**



# ENGINE



- New clutch cover.
- Weight reduction, improved clutch lubrication.



FULL RANGE

**SHERCO**



# SPECIFIC IMPROVEMENTS



2T STROKE

25<sub>SE</sub>

250  
300<sub>SE</sub>

4T STROKE

250  
300<sub>SEF</sub>



# FRONT WHEEL



- New front wheel: rim, spokes, axle and hub.
- The hubs have been redesigned to improve rigidity, the weight has been reduced by 500 gr and the spacer system incorporates anti-mud flanges.

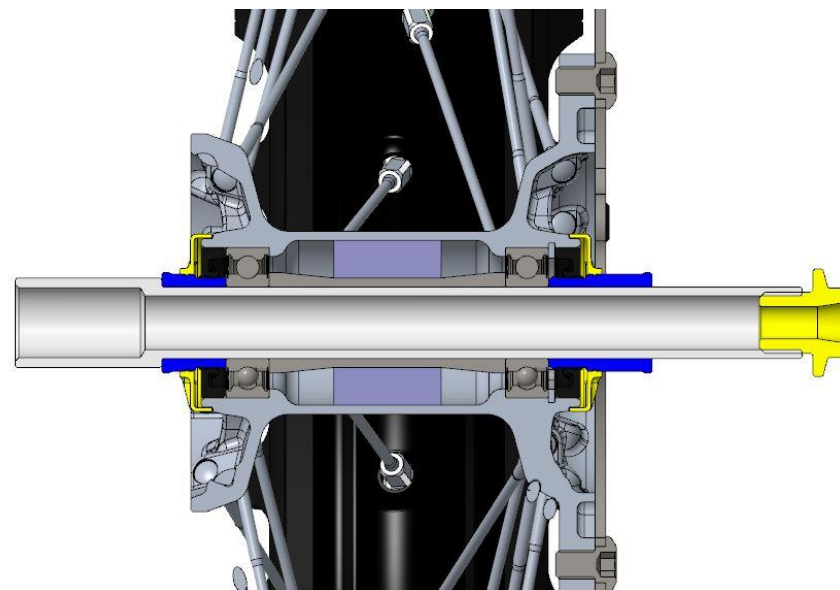

2T STROKE

125<sup>SE</sup>250<sup>SE</sup>300<sup>SE</sup>

4T STROKE

250<sup>SEF</sup>300<sup>SEF</sup>

SHERCO



# REAR WHEEL



- New rear wheel: rim, spokes, axle and hub.
- The hubs have been redesigned to improve rigidity, the weight has been reduced by 500 gr and the spacer system incorporates anti-mud flanges.

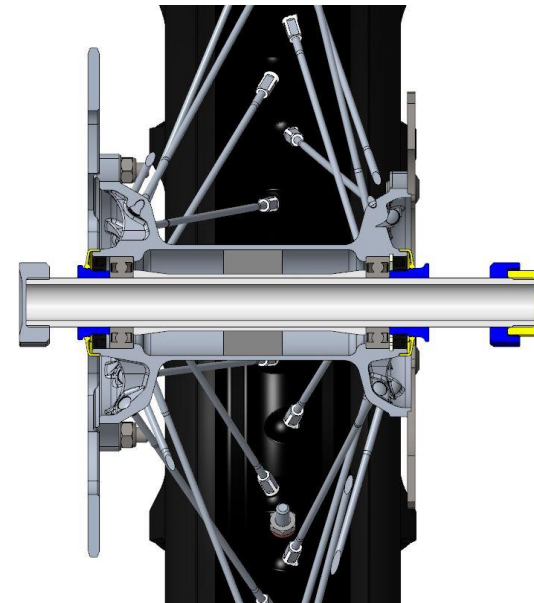

2T STROKE

125<sup>SE</sup>250<sup>SE</sup>300<sup>SE</sup>

4T STROKE

250<sup>SEF</sup>300<sup>SEF</sup>

SHERCO



# SWINGARM



- New design and new technology
- The weight has been reduced by 200 gr, the redesign provides improved riding comfort and traction, It also incorporates new bearings and seals. It is also designed to facilitate the adjustment of the chain tension, the chain tensioner system has 2 positions.



2T STROKE

125<sup>SE</sup>

250

300<sup>SE</sup>

4T STROKE

250

300<sup>SEF</sup>

SHERCO



# SPECIFIC IMPROVEMENTS



2T STROKE

25<sub>SE</sub>

250  
300<sub>SE</sub>



# CYLINDER HEAD BRACKETS



- New cylinder head support brackets.
- Reduced vibrations, better chassis rigidity, easier to assemble and disassemble, improved accessibility to the ignition coils.



2T STROKE

125<sup>SE</sup>

250

300<sup>SE</sup>

SHERCO



# SPECIFIC IMPROVEMENTS

4T STROKE

250  
300 SEF





# ENGINE IMPROVEMENTS



➤ New engine.

**4T STROKE**

**250  
300** **SEF**



# CENTRAL CRANKCASES

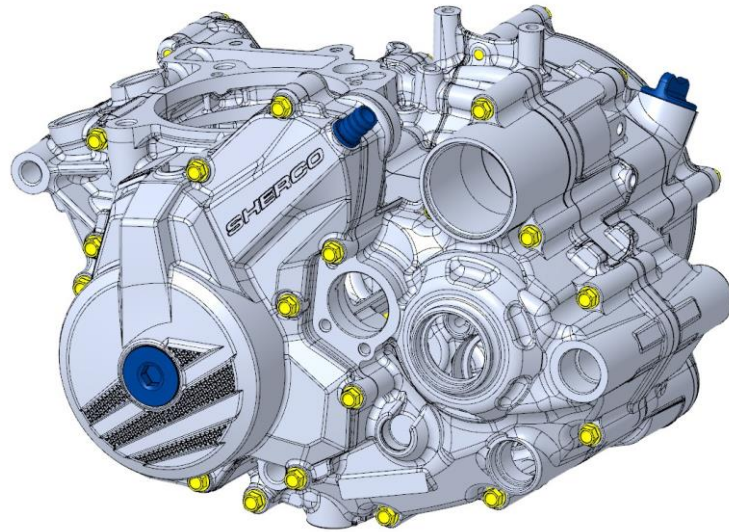

- Lighter and more compact engine central crankcases.
- New liquid cooling layout: improve engine cooling in front area of crankshaft.
- New lower piston cooling piston oil jet (X2) to improved piston cooling.

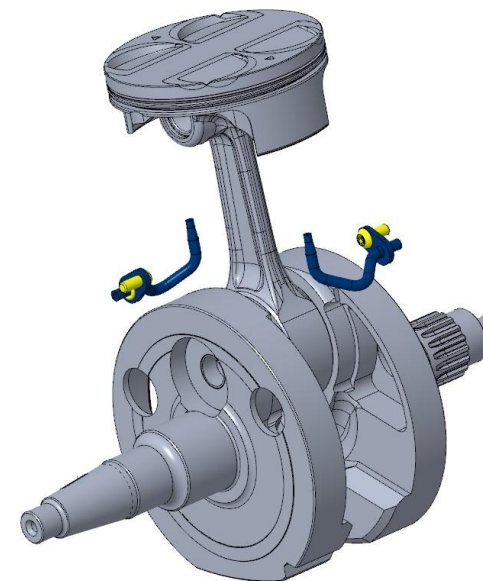
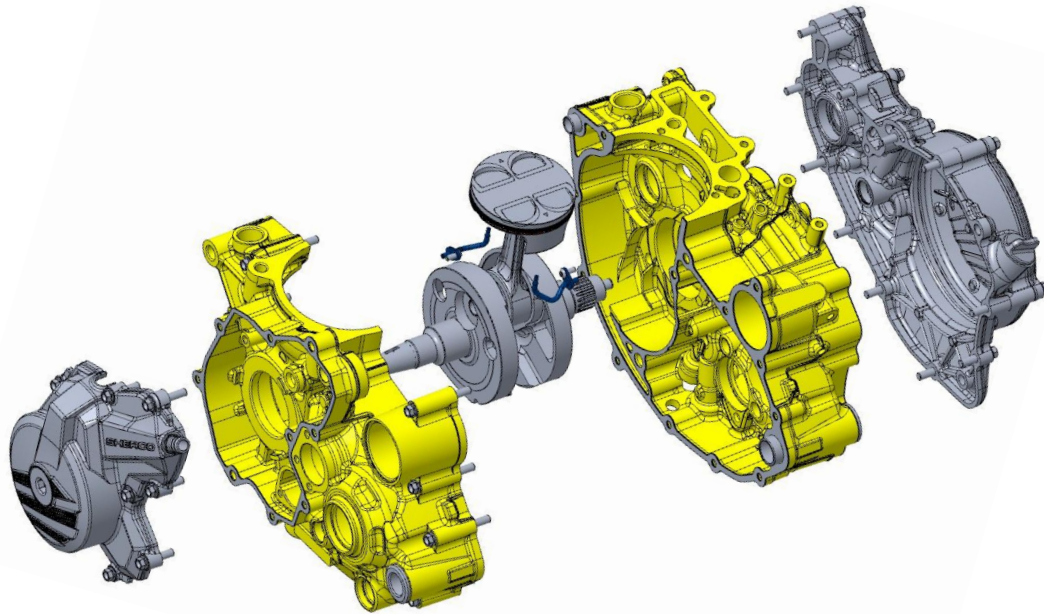

4T STROKE

250  
300  
SEP

SHERCO



# CLUTCH COVER

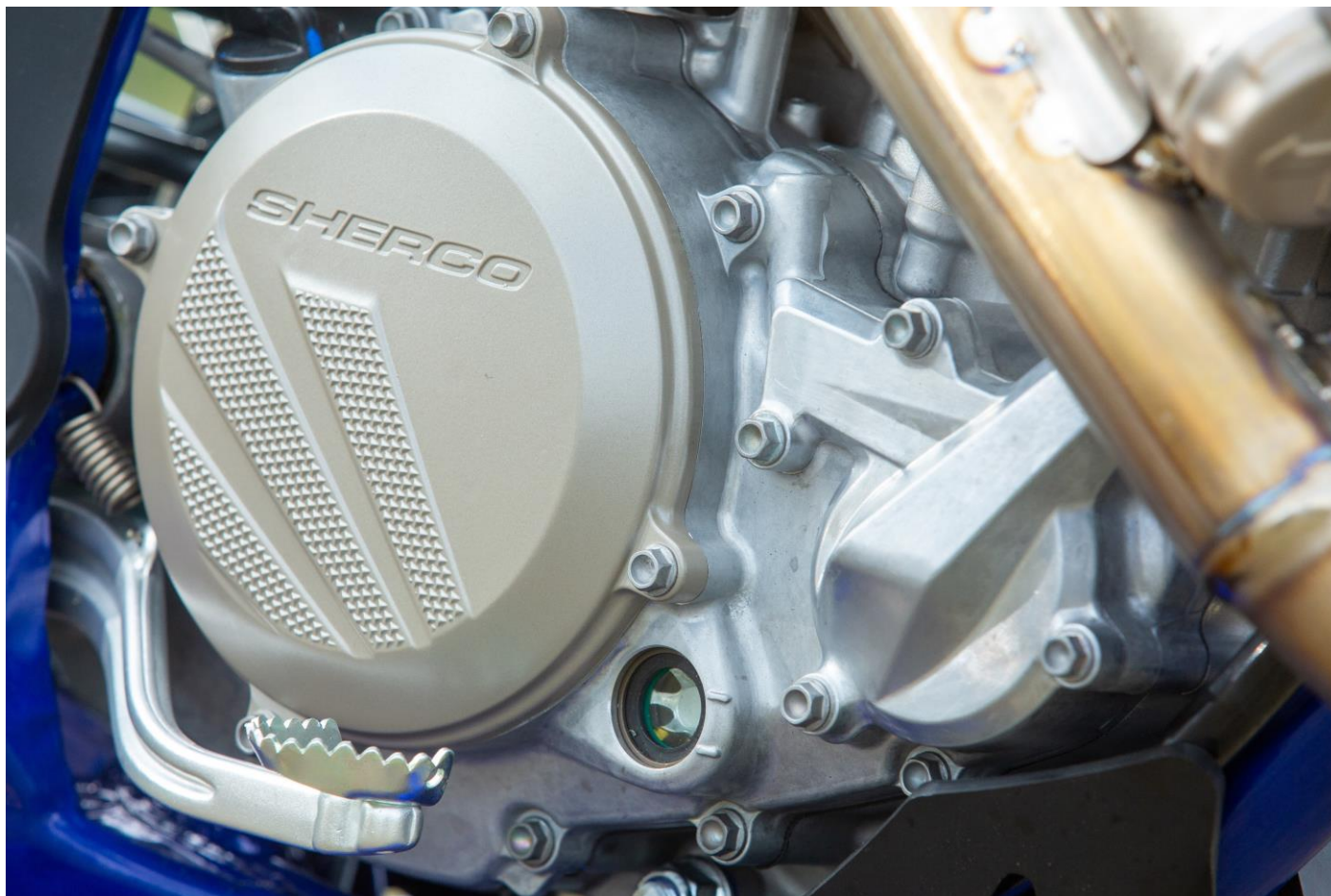

- New magnesium clutch cover.
- New visual identity and weight reduction.



4T STROKE

**250**  
**300** SEP

**SHERCO**



# IGNITION COVER



- New magnesium ignition cover (weight reduction)
- New visual identity

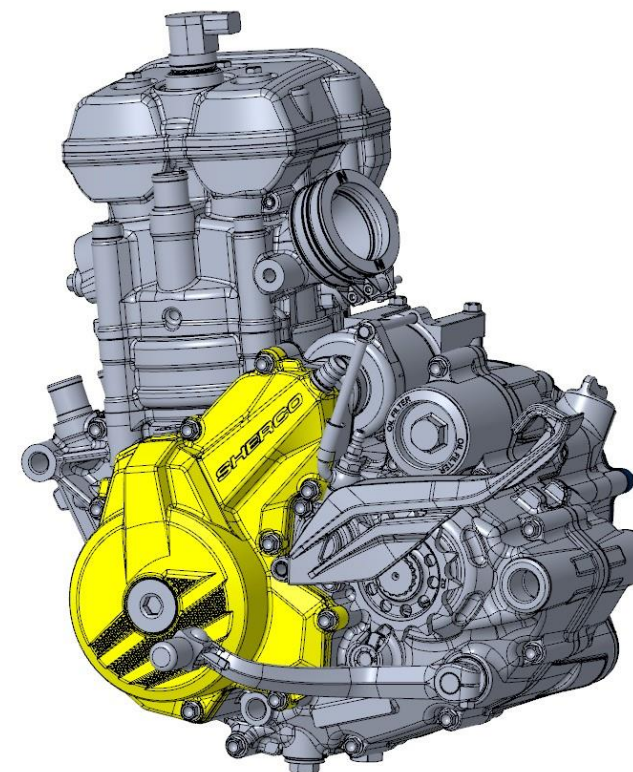

4T STROKE

**250**  
**300** SEF**SHERCO**



# CLUTCH CASING

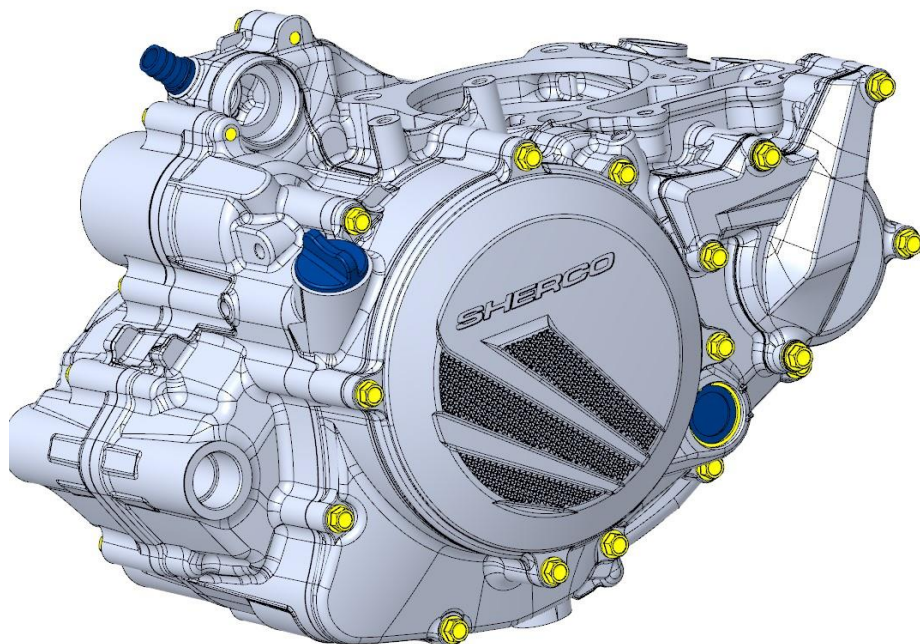

- New clutch casing.
- Repositioned oil level sight gage for ease of reading. Repositioned oil filler cap to provide easier filling.

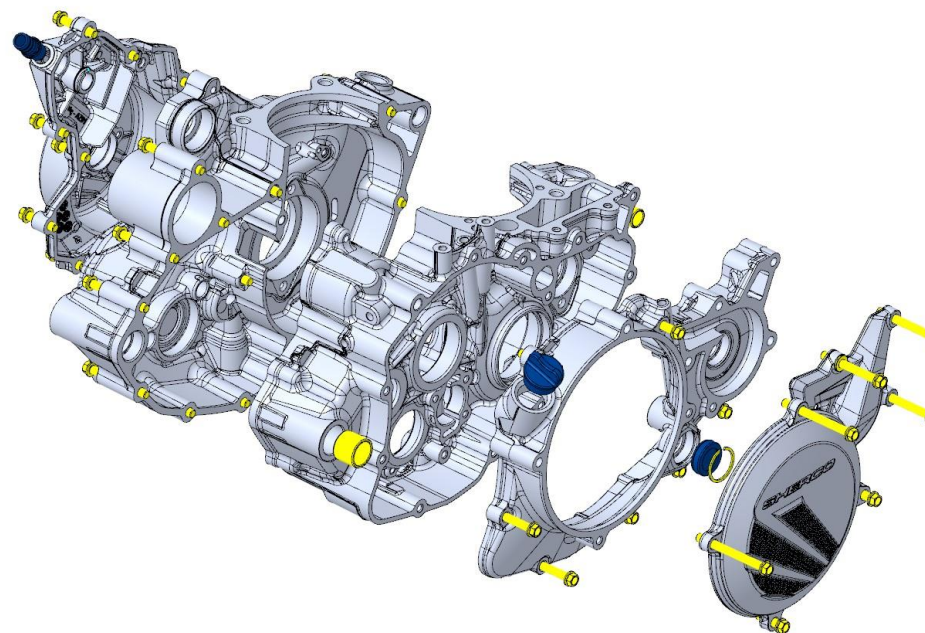

4T STROKE

**250**  
**300** SEF**SHERCO**

# ENGINE BALANCER

- New shaft and counterbalancer (integrated into the cam drive gear assembly).
- Weight reduction.

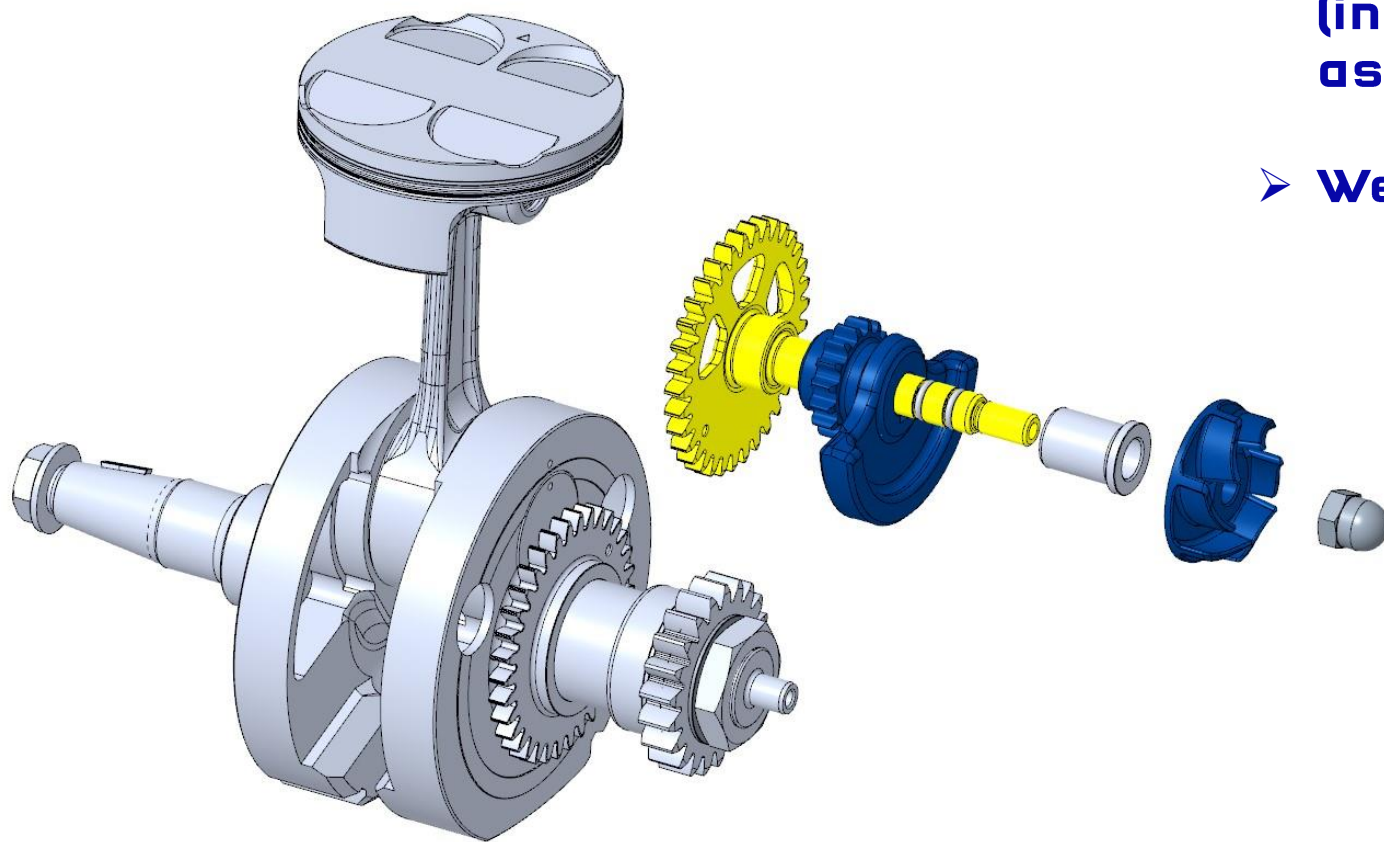

4T STROKE

**250**  
**300** SEF**SHERCO**

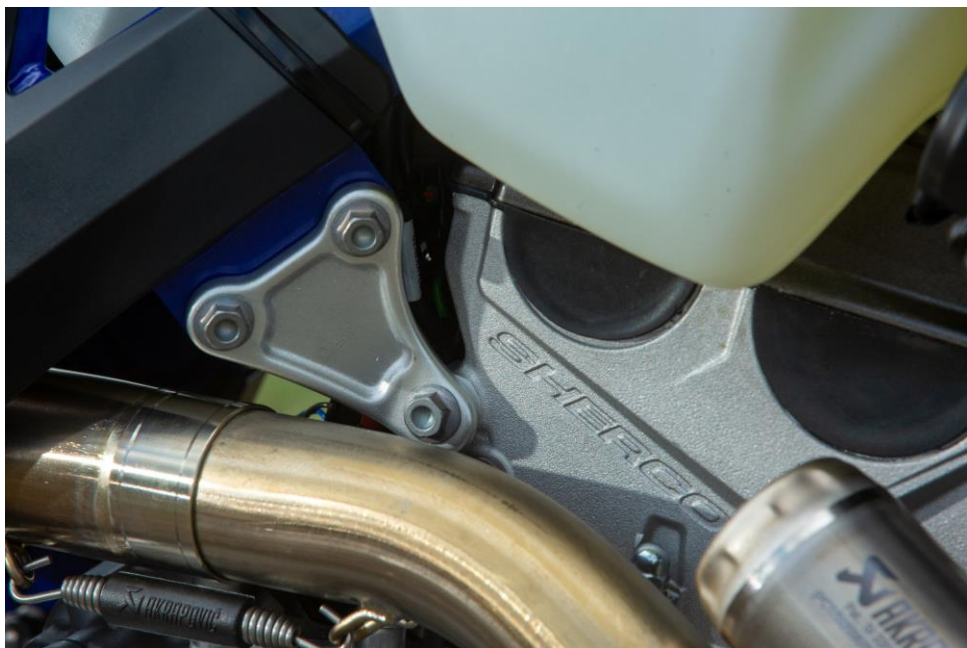

# CYLINDER HEAD 250<sup>SEF</sup>

**ENGINE**

- New cylinder head with improved acoustics (internal ribs on the distribution side for noise reduction).
- New visual identity.

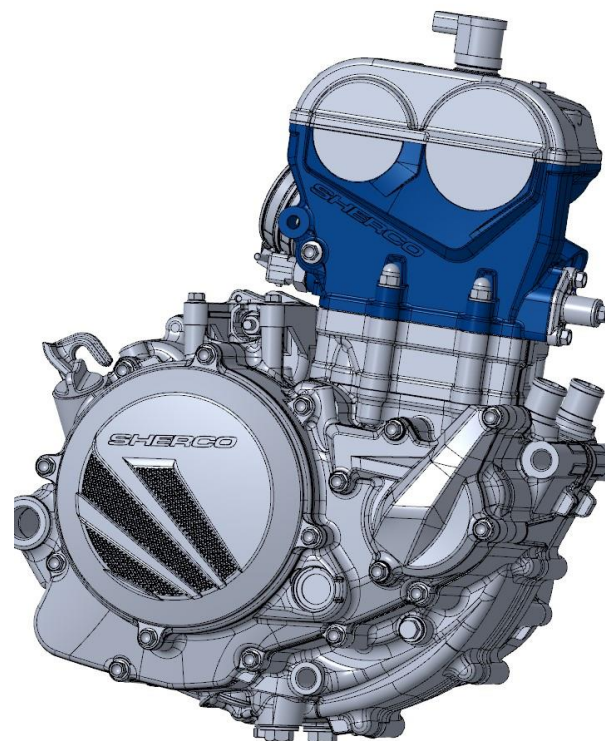
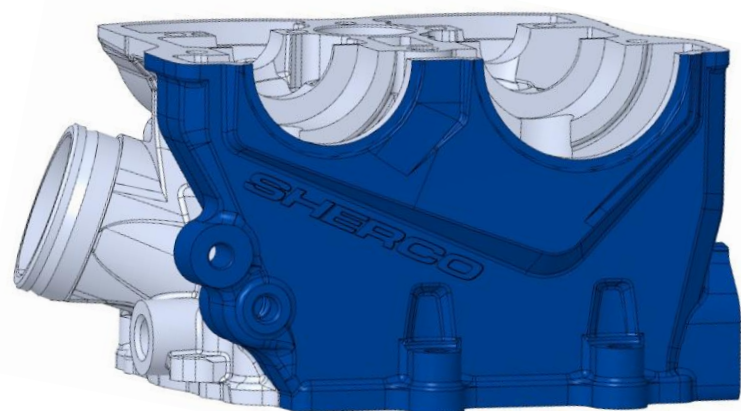
**SHERCO**

# CYLINDER HEAD 300<sup>SEF</sup>

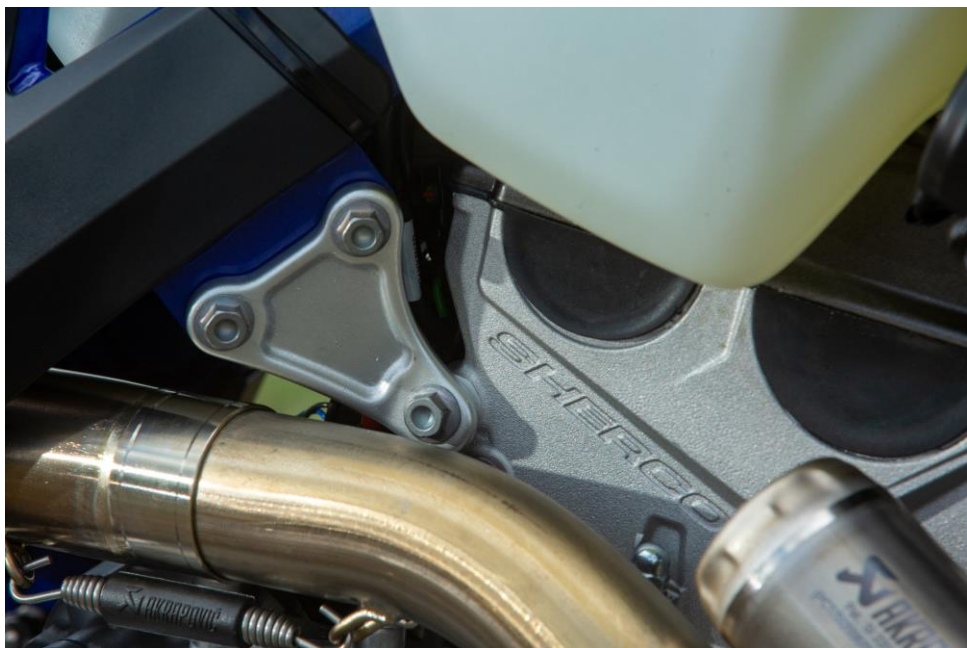

- New cylinder head with improved acoustics (internal ribs on the distribution side for noise reduction).
- New visual identity.
- New intake and exhaust ports.
- New intake ports improving the volumetric efficiency at low revs. The redesigned exhaust ports allow a wide power band at the top end.

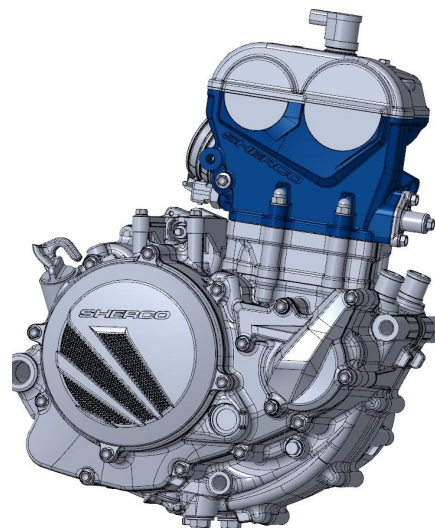
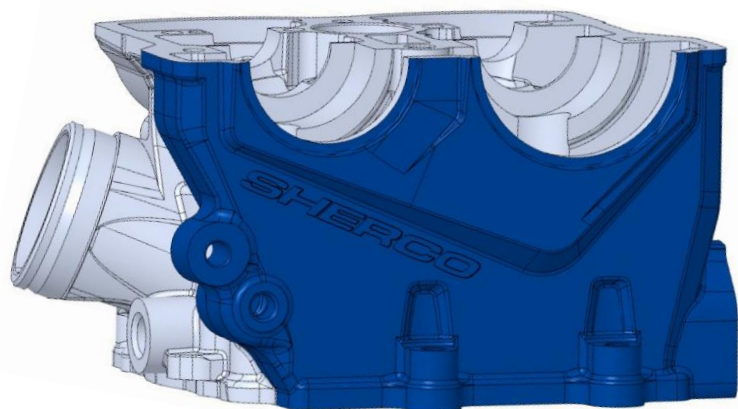



# DISTRIBUTION

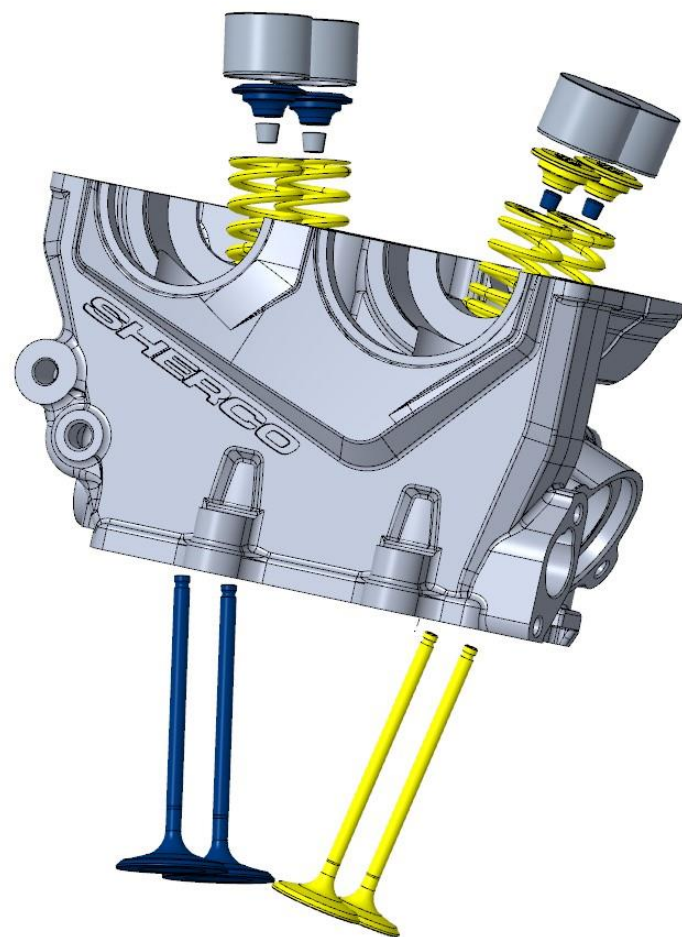

- New Titanium intake valves.
- New valve springs.
- The engine max RPM has been increased to 13,700 RPM. The engine is very linear and has an increased usable range.

4T STROKE

**250**  
**300** SEF**SHERCO**

# LUBRIFICATION

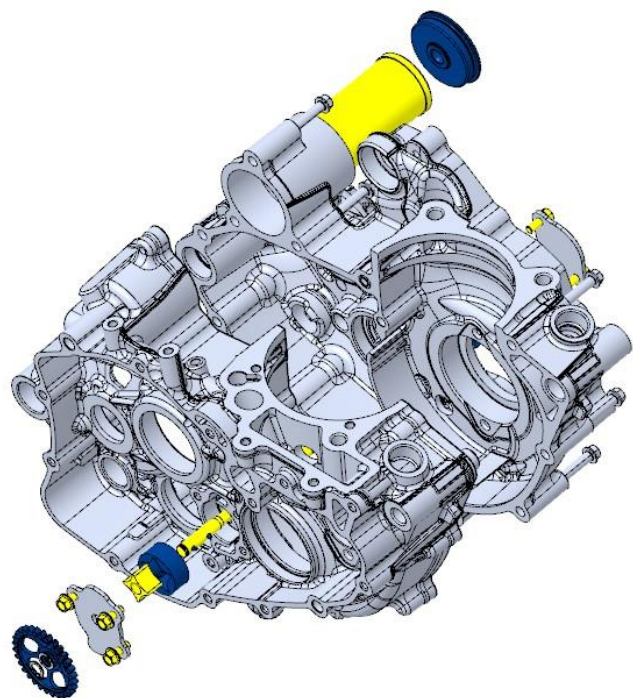

- New engine oil suction system (double suction pump) reduce all quantity in crankshaft area.
- Improved engine performance and significant reduction in engine braking.

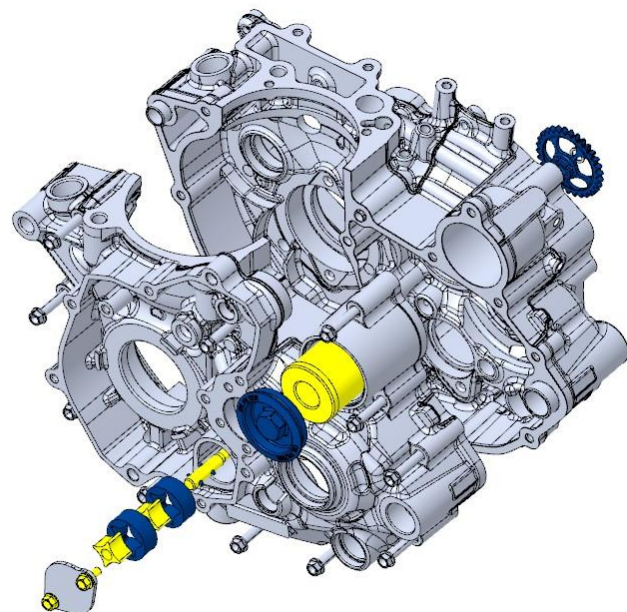

4T STROKE

**250**  
**300** SEF**SHERCO**



# GEAR POSITION SENSOR

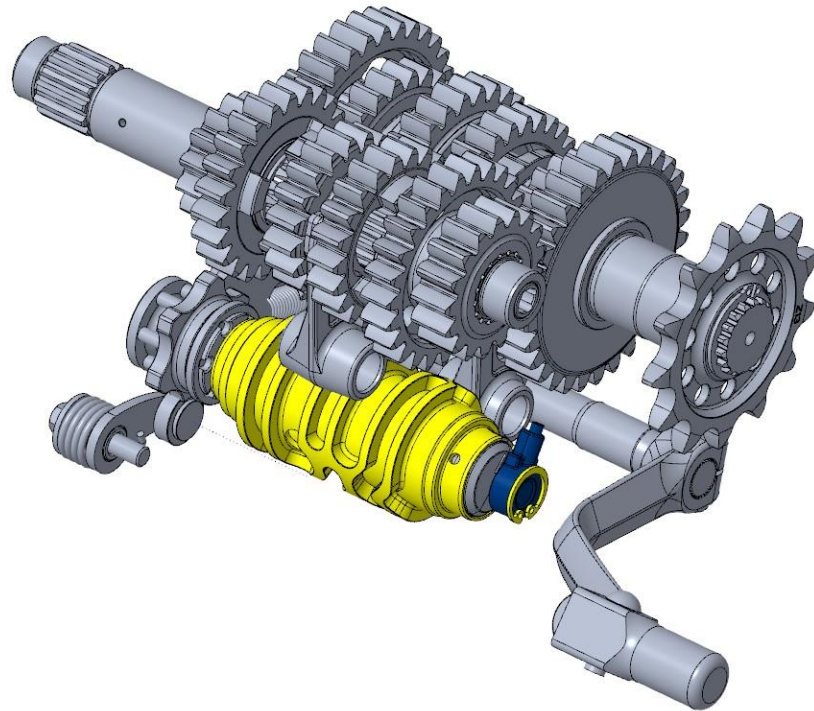

- Gear position sensor
- Allows the selection of a different MAP on each gear in order to have an optimal engine response in spite of a power gain.

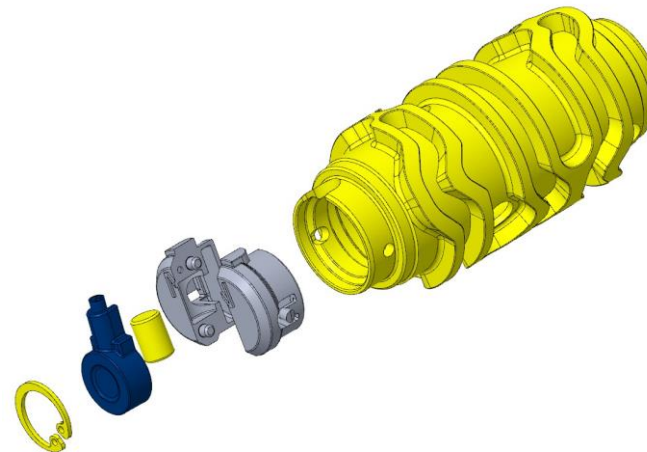

4T STROKE

**250**  
**300** SEF**SHERCO**

# INJECTOR BODY

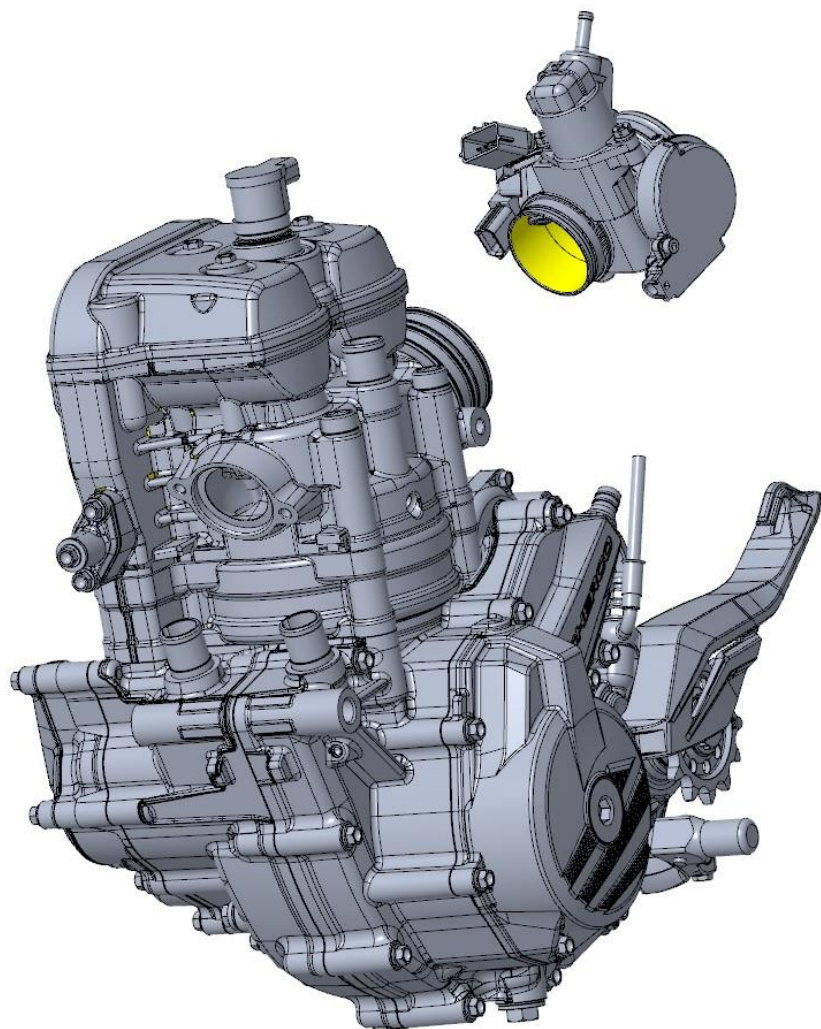

- Throttle body diameter increased from 38.5 mm to 42 mm.
- Increased power at high revs.

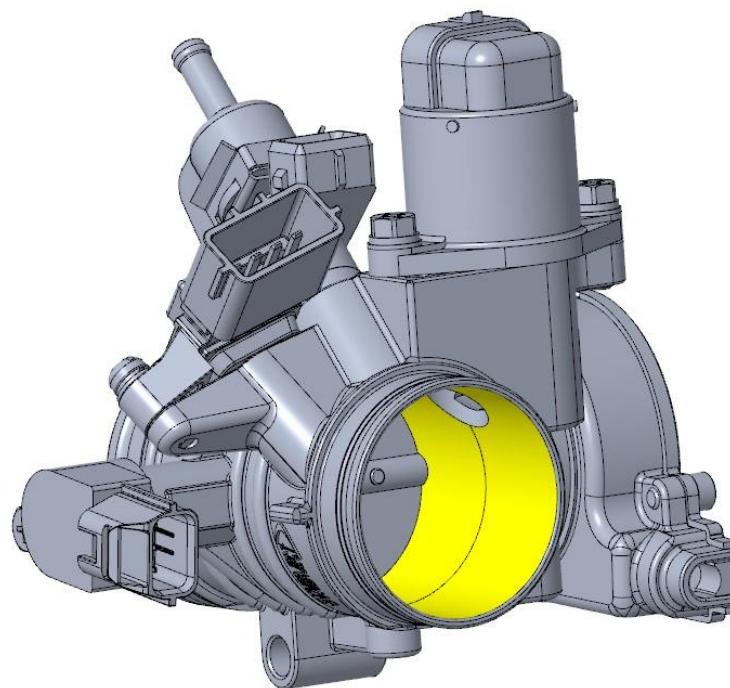



# SPECIFIC IMPROVEMENTS

4T STROKE

450  
500 SEF



# IMPROVEMENTS



- 2024 graphics kit.
- Headlight.
- Front fender.
- Front brake hose guide.
- Frame color paint.
- Aluminum rear sprocket.
- Clutch cover.

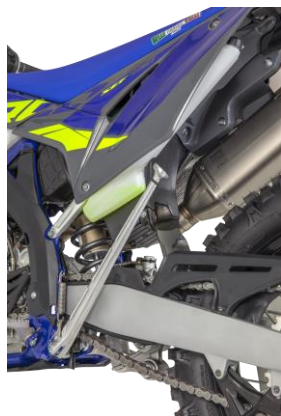

4T STROKE

450  
500 SEF

SHERCO



# SUMMARY

What is new ?	2 stroke			4 stroke			
	125 SE	250 SE	300 SE	250 SEF	300 SEF	450 SEF	500 SEF
2024 graphics kit	x	x	x	x	x	x	x
Headlight	x	x	x	x	x	x	x
Front fender	x	x	x	x	x	x	x
Front brake hose guides	x	x	x	x	x	x	x
Frame color paint	x	x	x	x	x	x	x
Aluminium rear sprocket	x	x	x	x	x	x	x
Clutch cover with new design	x	x	x	x	x	x	x
Front wheel	x	x	x	x	x		
Rear wheel	x	x	x	x	x		
Swingarm	x	x	x	x	x		
Cylinder head brackets	x	x	x				
Full new engine				x	x		
Magnesium clutch cover				x	x		
Magnesium ignition cover				x	x		
Titane intake valves				x	x		

# THE END



**SHERCO.COM**

**SHERCO recommends** **MOTUL**

SHERCO pictures, the company reserves the right, in order to improve its services, to change specifications and dimensions without prior notice. Pictures are not copy-written. There may be typographical errors in this literature. Pictures were taken abroad on private land. Photos © - J.M Pouget / M. Fant / MR. Sprang / F. Paul. Creation & réalisation

**MGT**

